

COUNTY SURVEYOR'S OFFICE
COURT HOUSE
KENOSHA, WIS.

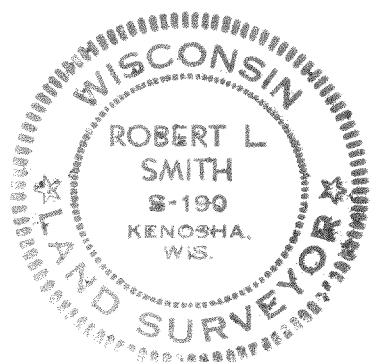

I hereby certify
that I surveyed
the property rep-
resented hereon
and that this sur-
vey is correct to
the best of my
knowledge and be-
lief. April, 1978.

Reg. Land Surveyor

Plat of Survey of:
LOT 25, BLOCK 5 IN
ROSE NIPPERSINK GARDENS
in SE $\frac{1}{4}$ Sec. 24-1-18
TOWN OF BLOOMFIELD
WALWORTH COUNTY, WIS.

for
F.D. Stumpf Realty
Twin Lakes Wis.

MRNG-54

118-2693